



**Oyster ceiling light
Adjustable Sensor
By DIP Switch**



Product Description



Ceiling light with Sensor

GLCPro-PFS20%-3K-12W

Voltage: AC100-240V
 Size: Ø275*100mm
 Power:12W, PF:>0.9
 CCT: 3000K 4000K
 LED: 2835 SMD CRI80
 Beam angle: 120°
 Lumen: 996-1068lm
 IP:20
 NW:0,8kg, GW: 0,9kg
 daylight and the corridor function that goes down to 20%

GLCPro-PFS20%-3K-25W

Voltage: AC200-240V
 Size: Ø350*110mm
 Power:25W, PF: >0.9
 CCT: 3000K 4000K
 LED: 2835 SMD CRI80
 Beam angle: 120°
 Lumen: 1870-2120lm
 IP:20
 NW:1.1kg, GW:1.2kg
 daylight and the corridor function that goes down to 20%

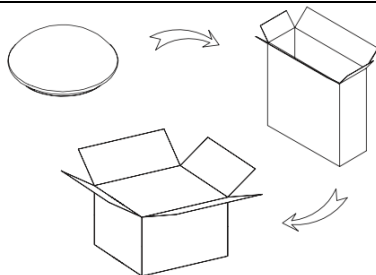

Packaging information

GLCPro-PFS20%-3K-12W

Single-Pack: 340x140x335mm,
 Multi-pack: 730x350x360mm, 5pcs/multi, 0,092CBM,

GLCPro-PFS20%-3K-25W

Single-Pack: 390x145x385mm,
 Multi-pack: 750x400x410mm, 5pcs/multi, 0,123CBM,



Installation Guide

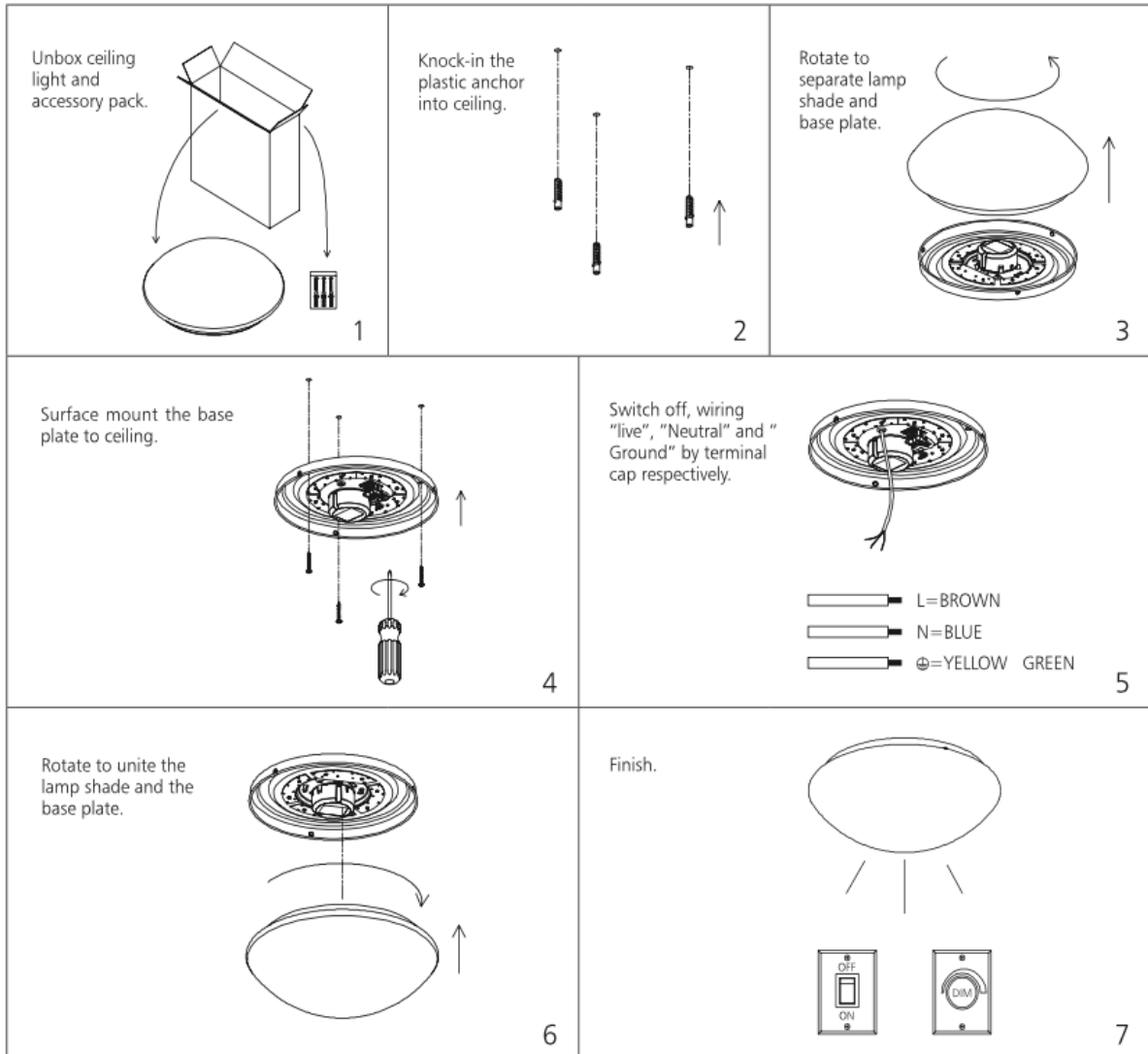



Sensor Setting

By selecting the combination on the DIP switch, sensor data can be precisely set for each specific application.

		1	2	
	I	●	●	100%
	II	○	●	75%
	III	●	○	50%
	IV	○	○	10%

Detection area

Detection area can be reduced by selecting the combination on the DIP switches to fit precisely each application.

		3	4	
	I	●	●	10s
	II	○	●	90s
	III	●	○	3min
	IV	○	○	10min

Hold time

Refers to the time period the lamp remains at 100% illumination after no motion detected.

		5	6	
	I	●	●	Disable
	II	○	●	50Lux
	III	●	○	15Lux
	IV	○	○	5Lux

Daylight sensor

The sensor can be set to only allow the lamp to illuminate below a defined ambient brightness threshold.

When set to Disable mode, the daylight sensor will switch on the lamp when motion is detected regardless of ambient light level.

50lux: twilight operation, 15lux, 5lux: darkness operation only.

		7	8	
	I	●	●	0s
	II	○	●	30s
	III	●	○	10min
	IV	○	○	+∞

Corridor function(Stand-by period)

Refers to the time period the lamp remains at a low light level before it completely switches off in the long absence of people.

When set to "+∞", the low light is maintained until motion is detected.

When set to "0s", the light will turn off after hold time.